

C-FILTER D-SUB HIGH DENSITY – IP67

Plug connector – Solder pin – Angled – .220" / 5.6 mm –
Precision machined contacts – Metal bracket

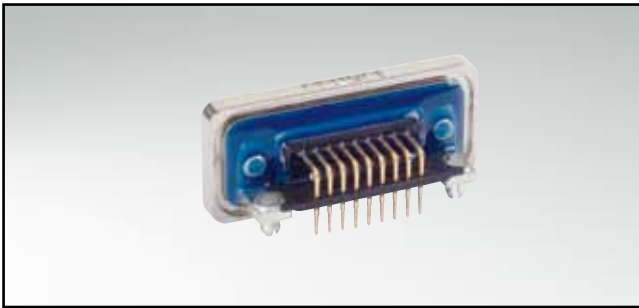

RoHS compliant – CSA listed, File No.: LR 115000-1 – UL listed, File No.: E 202784

DESCRIPTION

- Mounting styles:
 - with 4-40 UNC or M3 threaded insert
 - with mounting bracket, PCB clip and 4-40 UNC or M3 threaded insert
- Quality class 3 (also available in quality class 1)
- Shell: Brass tin plated (stainless steel on request)
- Nickel plated die-cast frame (Black plastic frame on request)

PRODUCT DRAWING

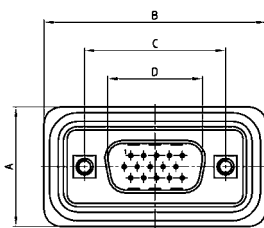

No. of pos.	A +0.20	B +0.20	C	D +0.25	E -0.30
15	21.10	39.40	25.00 ^{+0.12} _{-0.13}	16.79	5.82
26	21.10	47.70	33.30 ^{+0.15} _{-0.10}	25.12	5.82
44	21.10	61.40	47.04 ^{+0.13}	38.84	5.69
62	21.10	77.90	63.50 ^{+0.13}	55.30	5.69

PCB-Layout: Kat1kgWA

Mounting style: Threaded insert

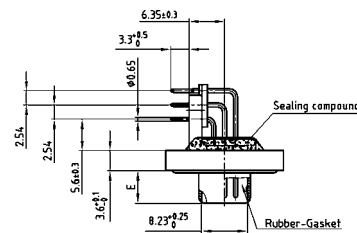
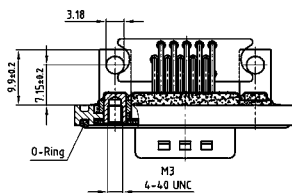

Mounting style: PCB clip, threaded insert

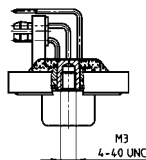

ORDER DATA

Capacitance 180 pF

PLUG CONNECTOR			PLUG CONNECTOR		
No. of pos.	Mounting style	Part Number	No. of pos.	Mounting style	Part Number
15	M3 Threaded insert	6 HDF15PAY01R10 X	15	PCB clip / M3 Threaded insert	6 HDF15PAY01R30 X
26	M3 Threaded insert	6 HDF26PAY01R10 X	26	PCB clip / M3 Threaded insert	6 HDF26PAY01R30 X
44	M3 Threaded insert	6 HDF44PAY01R10 X	44	PCB clip / M3 Threaded insert	6 HDF44PAY01R30 X
62	M3 Threaded insert	6 HDF62PAY01R10 X	62	PCB clip / M3 Threaded insert	6 HDF62PAY01R30 X
15	4-40 UNC Threaded insert	6 HDF15PAY01R20 X	15	PCB clip / 4-40 UNC Threaded insert	6 HDF15PAY01R40 X
26	4-40 UNC Threaded insert	6 HDF26PAY01R20 X	26	PCB clip / 4-40 UNC Threaded insert	6 HDF26PAY01R40 X
44	4-40 UNC Threaded insert	6 HDF44PAY01R20 X	44	PCB clip / 4-40 UNC Threaded insert	6 HDF44PAY01R40 X
62	4-40 UNC Threaded insert	6 HDF62PAY01R20 X	62	PCB clip / 4-40 UNC Threaded insert	6 HDF62PAY01R40 X

PCB clip .122" / 3.1 ± .004" / 0.10 mm hole diameter and .063" / 1.6 mm circuit board thickness

C-FILTER D-SUB HIGH DENSITY – IP67

Plug connector – Solder pin – Angled – .220" / 5.6 mm –
Precision machined contacts – Metal bracket

ORDER DATA

Capacitance 370 pF

PLUG CONNECTOR			PLUG CONNECTOR		
No. of pos.	Mounting style	Part Number	No. of pos.	Mounting style	Part Number
15	M3 Threaded insert	6 HDF15PAY03R10 X	15	PCB clip / M3 Threaded insert	6 HDF15PAY03R30 X
26	M3 Threaded insert	6 HDF26PAY03R10 X	26	PCB clip / M3 Threaded insert	6 HDF26PAY03R30 X
44	M3 Threaded insert	6 HDF44PAY03R10 X	44	PCB clip / M3 Threaded insert	6 HDF44PAY03R30 X
62	M3 Threaded insert	6 HDF62PAY03R10 X	62	PCB clip / M3 Threaded insert	6 HDF62PAY03R30 X
15	4-40 UNC Threaded insert	6 HDF15PAY03R20 X	15	PCB clip / 4-40 UNC Threaded insert	6 HDF15PAY03R40 X
26	4-40 UNC Threaded insert	6 HDF26PAY03R20 X	26	PCB clip / 4-40 UNC Threaded insert	6 HDF26PAY03R40 X
44	4-40 UNC Threaded insert	6 HDF44PAY03R20 X	44	PCB clip / 4-40 UNC Threaded insert	6 HDF44PAY03R40 X
62	4-40 UNC Threaded insert	6 HDF62PAY03R20 X	62	PCB clip / 4-40 UNC Threaded insert	6 HDF62PAY03R40 X

Capacitance 830 pF

PLUG CONNECTOR			PLUG CONNECTOR		
No. of pos.	Mounting style	Part Number	No. of pos.	Mounting style	Part Number
15	M3 Threaded insert	6 HDF15PAY04R10 X	15	PCB clip / M3 Threaded insert	6 HDF15PAY04R30 X
26	M3 Threaded insert	6 HDF26PAY04R10 X	26	PCB clip / M3 Threaded insert	6 HDF26PAY04R30 X
44	M3 Threaded insert	6 HDF44PAY04R10 X	44	PCB clip / M3 Threaded insert	6 HDF44PAY04R30 X
62	M3 Threaded insert	6 HDF62PAY04R10 X	62	PCB clip / M3 Threaded insert	6 HDF62PAY04R30 X
15	4-40 UNC Threaded insert	6 HDF15PAY04R20 X	15	PCB clip / 4-40 UNC Threaded insert	6 HDF15PAY04R40 X
26	4-40 UNC Threaded insert	6 HDF26PAY04R20 X	26	PCB clip / 4-40 UNC Threaded insert	6 HDF26PAY04R40 X
44	4-40 UNC Threaded insert	6 HDF44PAY04R20 X	44	PCB clip / 4-40 UNC Threaded insert	6 HDF44PAY04R40 X
62	4-40 UNC Threaded insert	6 HDF62PAY04R20 X	62	PCB clip / 4-40 UNC Threaded insert	6 HDF62PAY04R40 X

PCB clip .122" / 3.1 ± .004" / 0.10 mm hole diameter and .063" / 1.6 mm circuit board thickness